

Příloha č. 2 Obce Janov u J. o místním poplatku za užívání veřejného prostoru

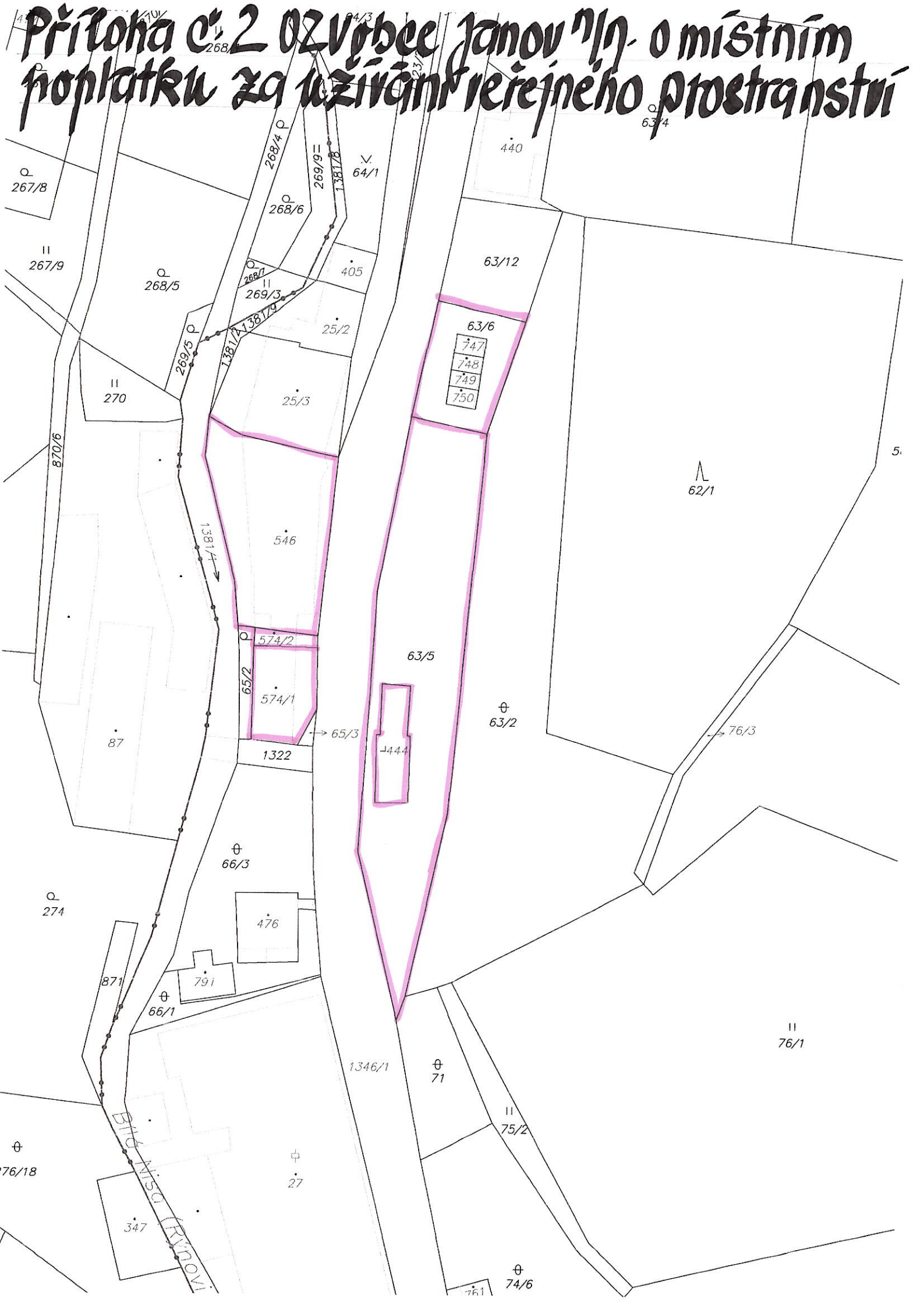

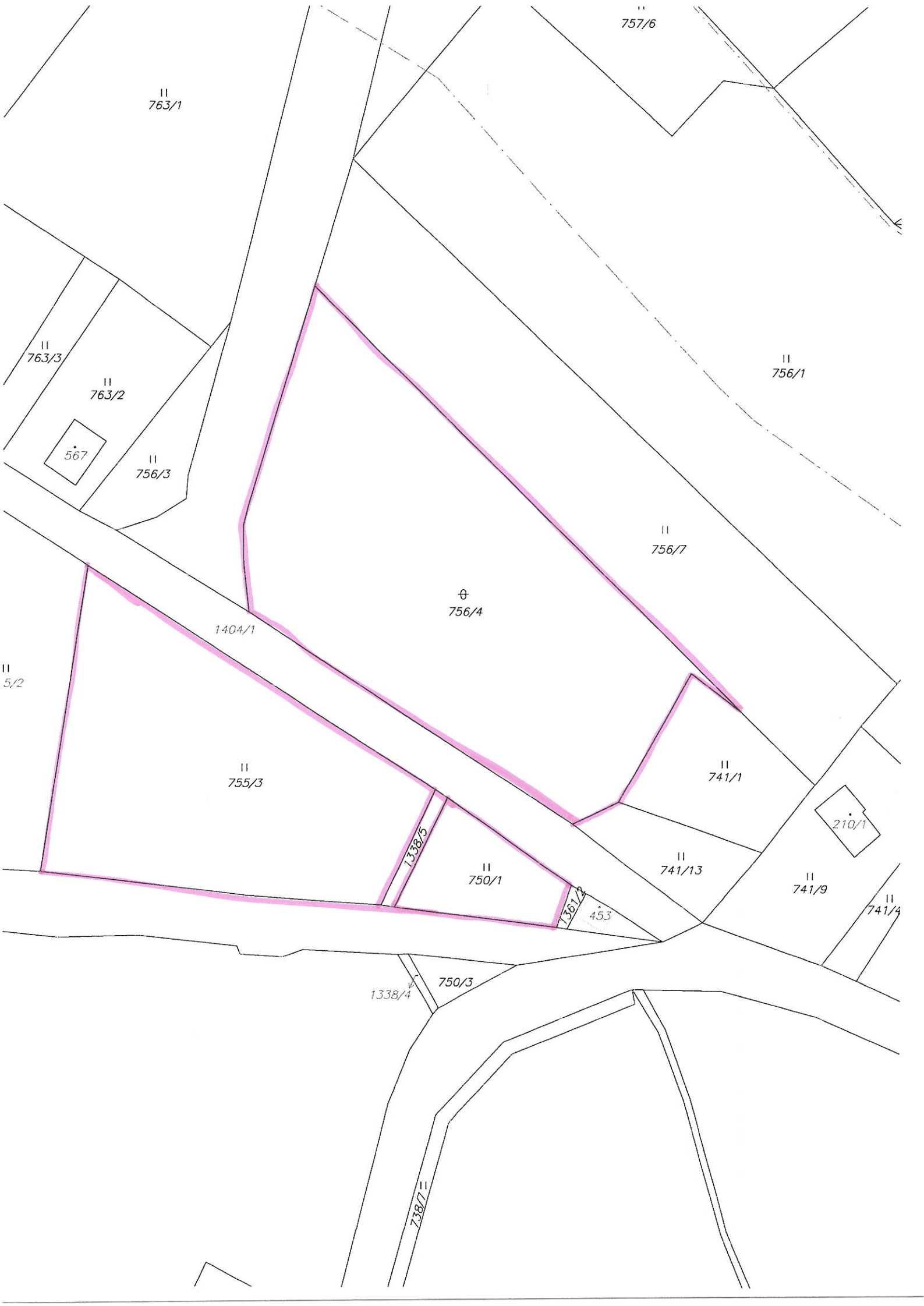

757/6

||
763/1

||
763/3

||
763/2

567

||
756/3

||
756/1

||
756/7

⊕
756/4

1404/1

||
5/2

||
755/3

||
741/1

7338/5

||
750/1

||
741/13

210/1

||
741/9

||
741/4

7361/2

455

750/3

1338/4

1338/7

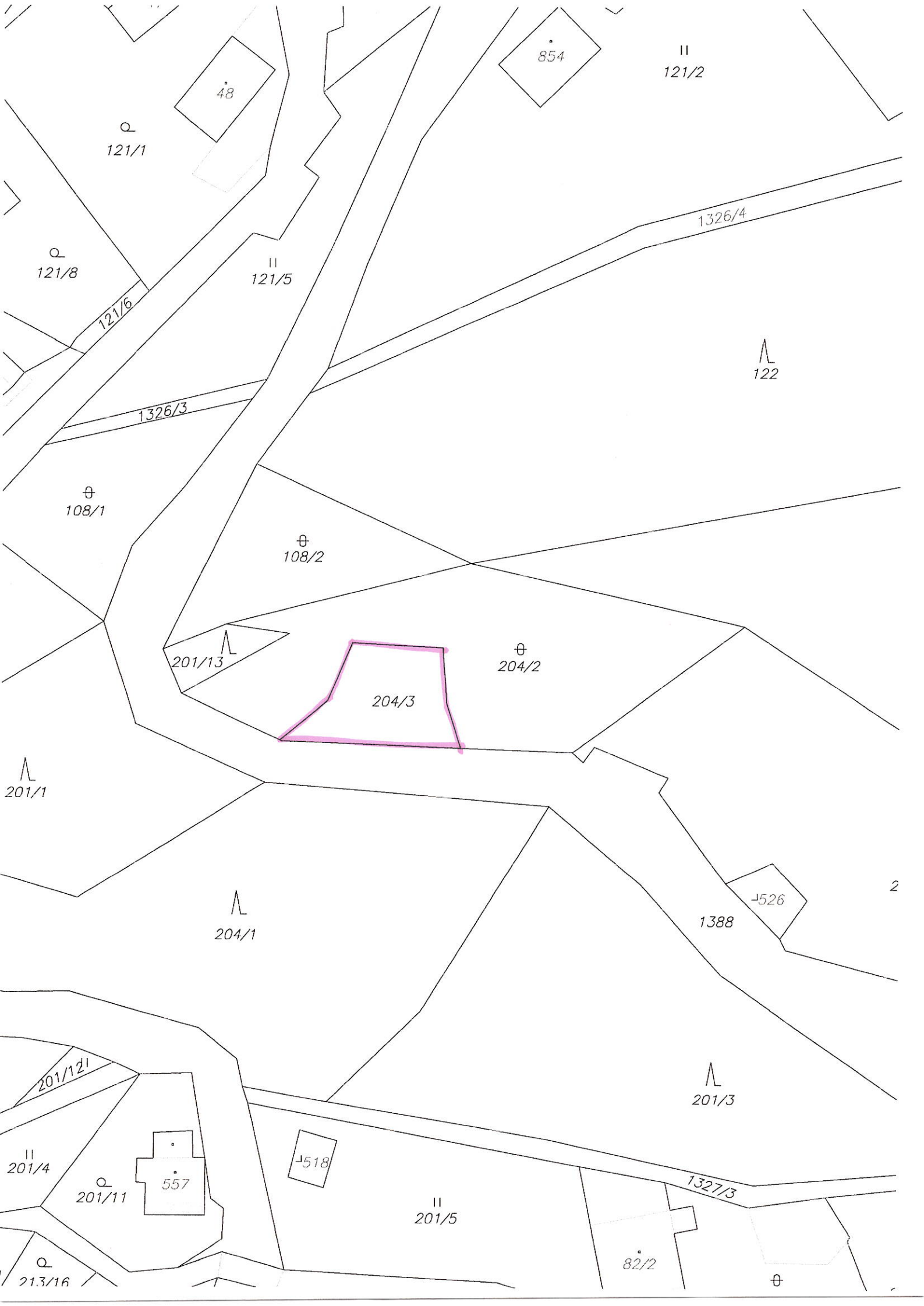

121/1

48

854

121/2

121/8

121/5

1326/4

121/6

1326/3

122

108/1

108/2

201/13

204/2

204/3

201/1

204/1

1388

526

201/12

201/3

201/4

201/11

557

518

201/5

1327/3

213/16

82/2

⊕





539

416
1341/6

1318/1

1318/2

138

477

2/2

2/1

1318/3

502

20

1413

12/10

1408

1319/1

3

10

2

19

12/1

18/1

11

12/13

607

4

12/11

359

513

552

553

547

23/1

5/18

12/6

548

13/1

555

5/19

12/8

12/12

441

16/1

16/2

8/2

13/1

12/4

12/3

357

484

13/5

13/7

1405

13/2

11

1428

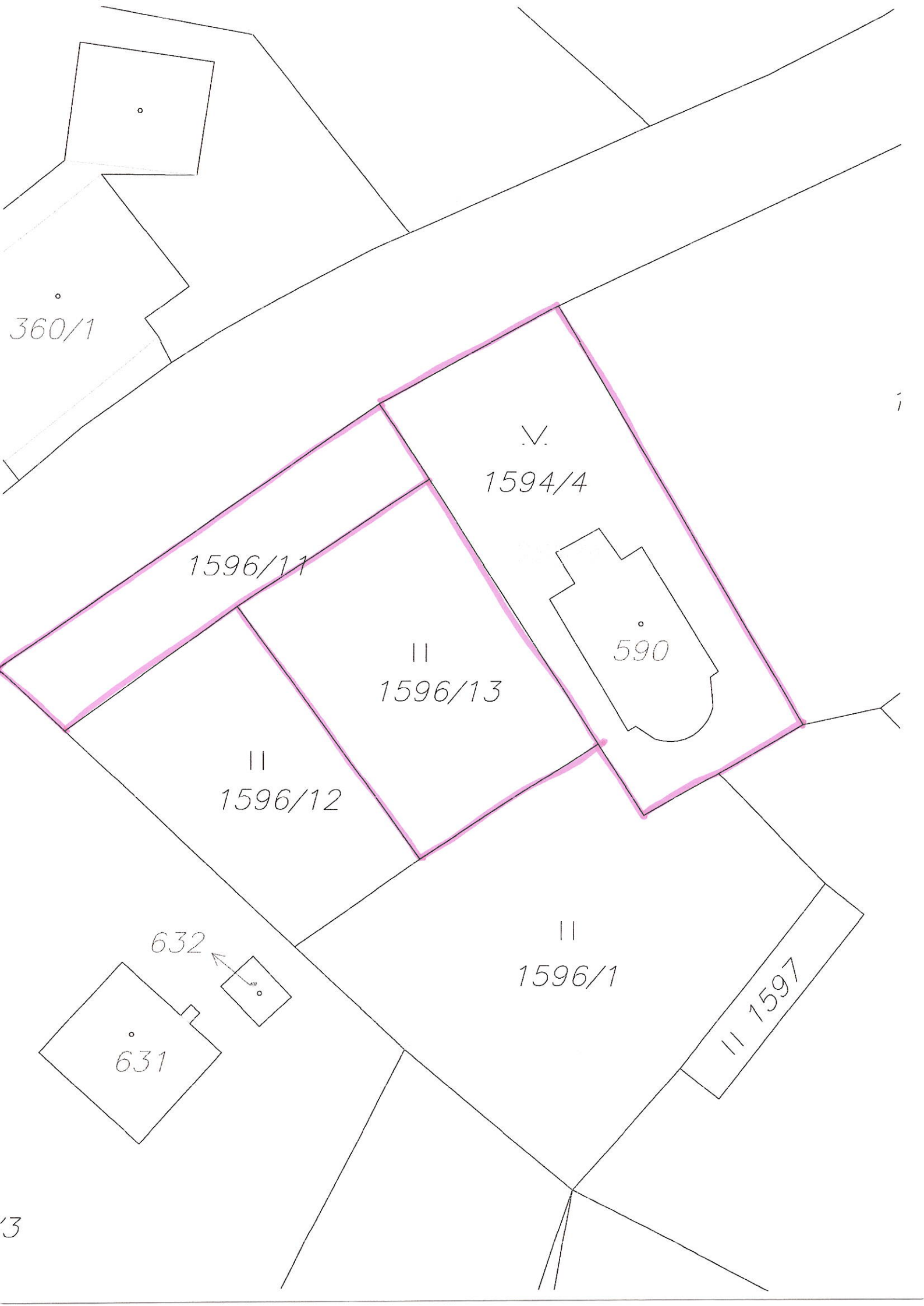

360/1

V.
1594/4

1596/11

II
1596/13

590

II
1596/12

II
1596/1

II 1597

631

632

3

1b #

886
814/1
822/1

Příloha č. 2 OZV obce Janov 4 o místním poplatku za užívání veřejného prostoru

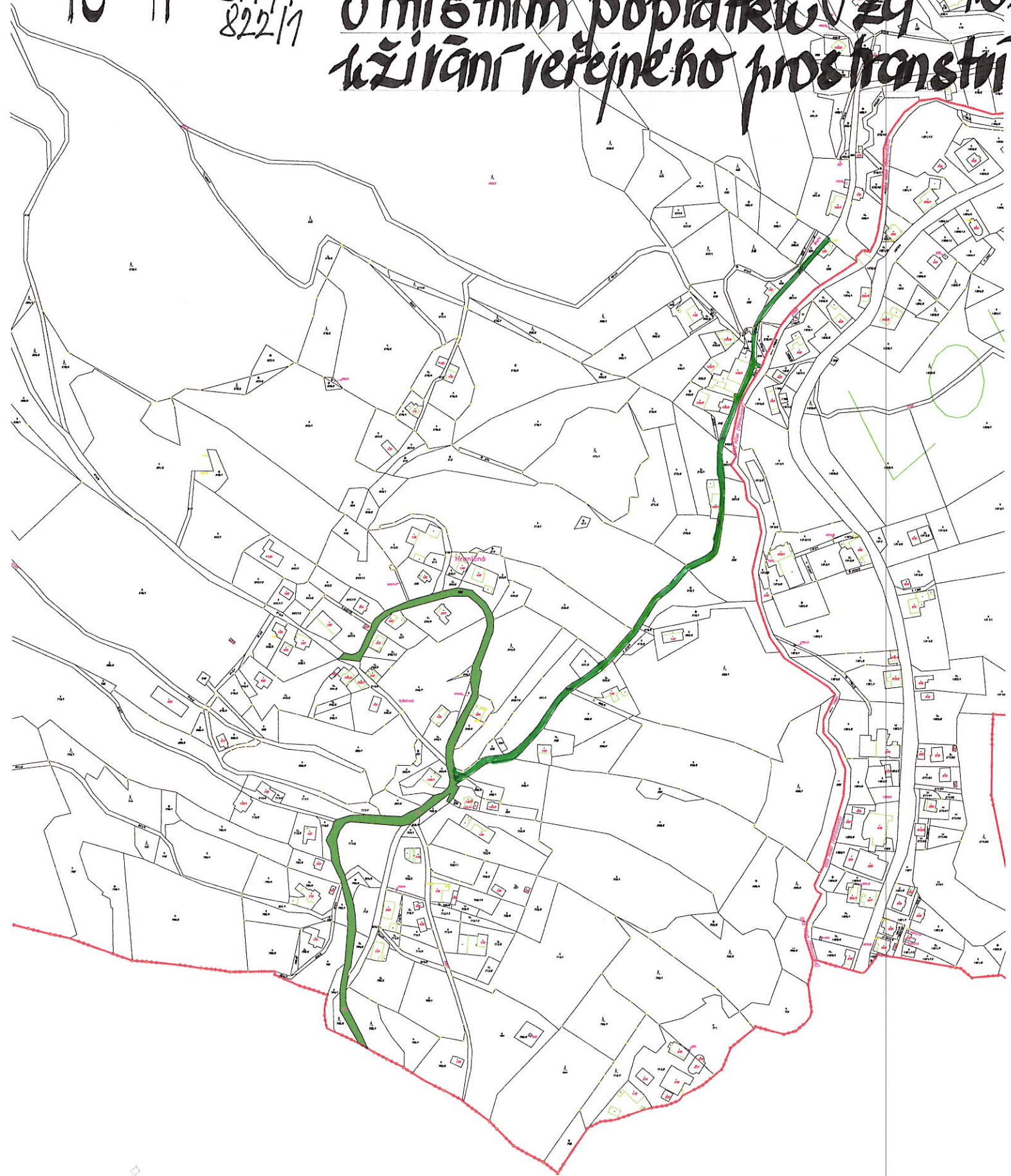

vice

26 J 1392

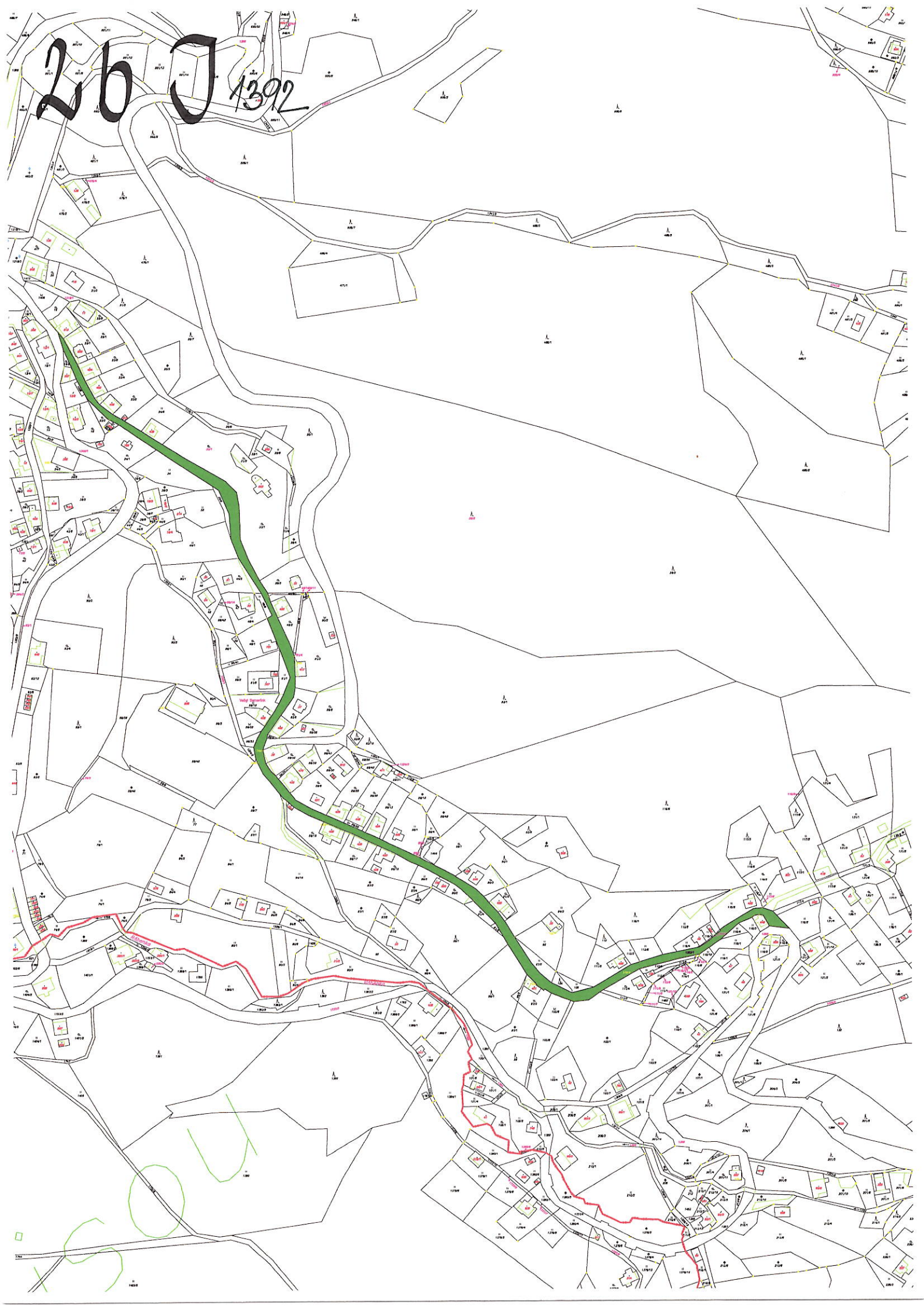

36 # 887

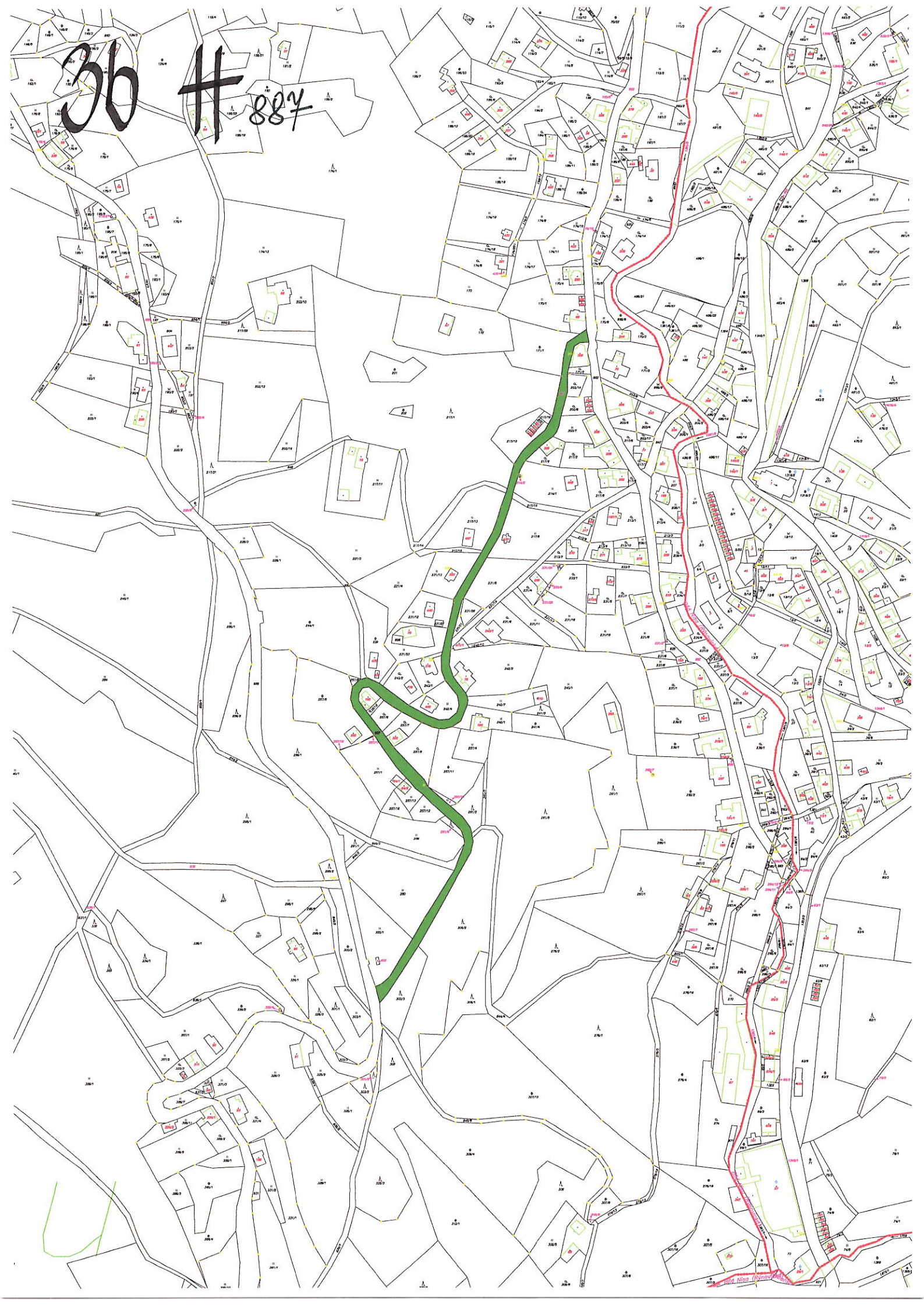

4b + 1d
g

1400/1

1399
1400/1

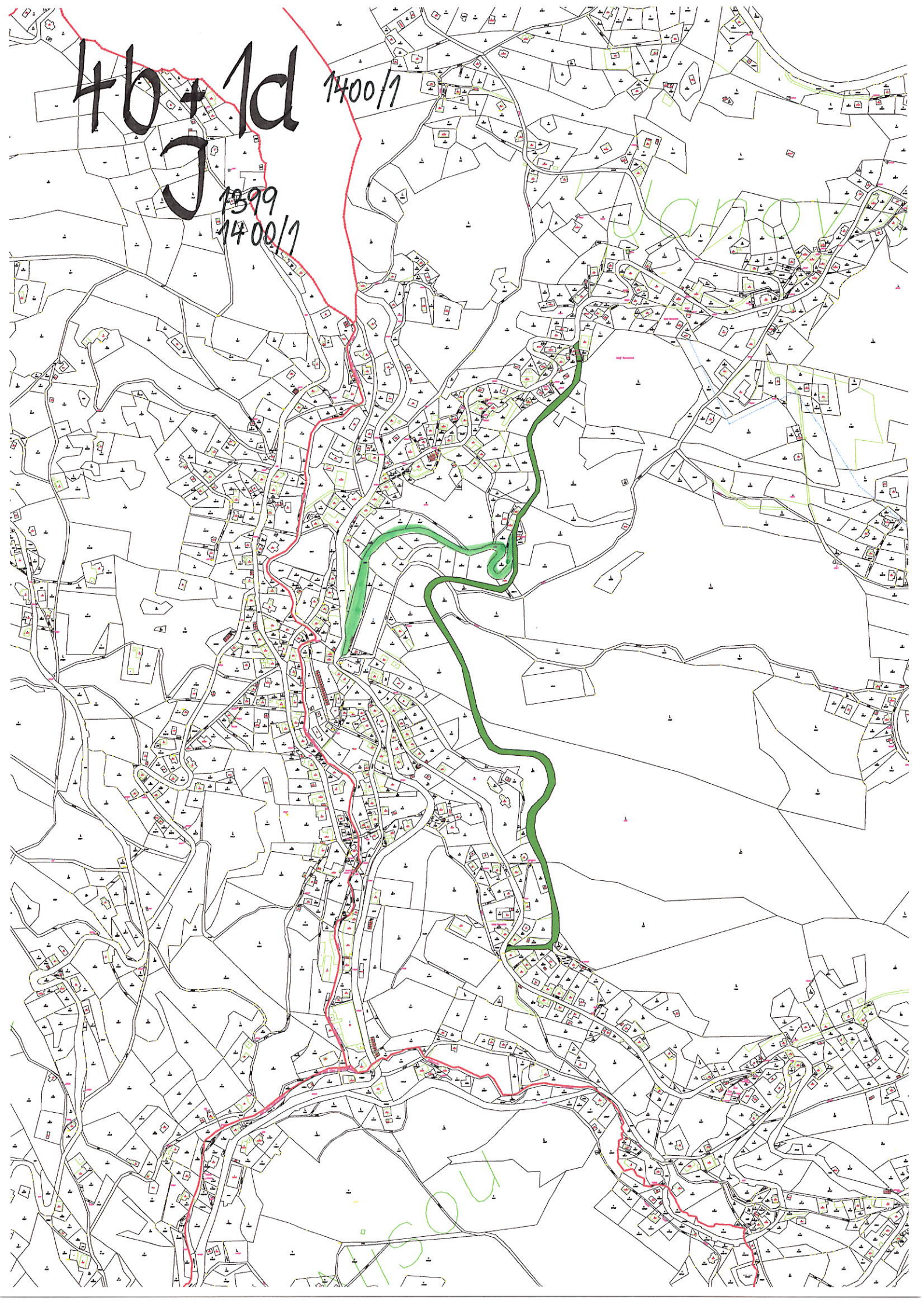

5b J

1353/2
1041/3
1353/8

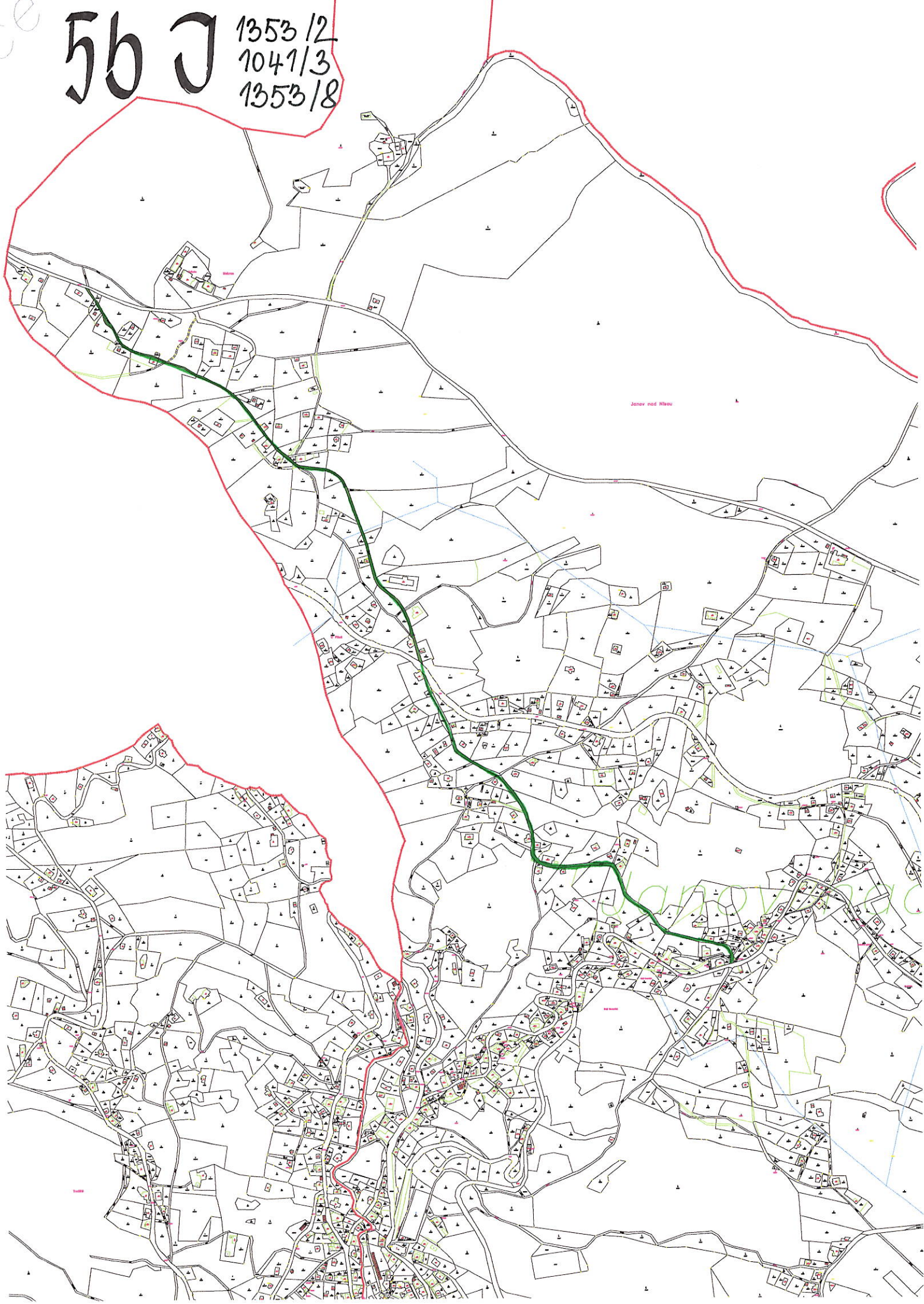

66 J

1404/17
1365/17

stuv Dül u Ja

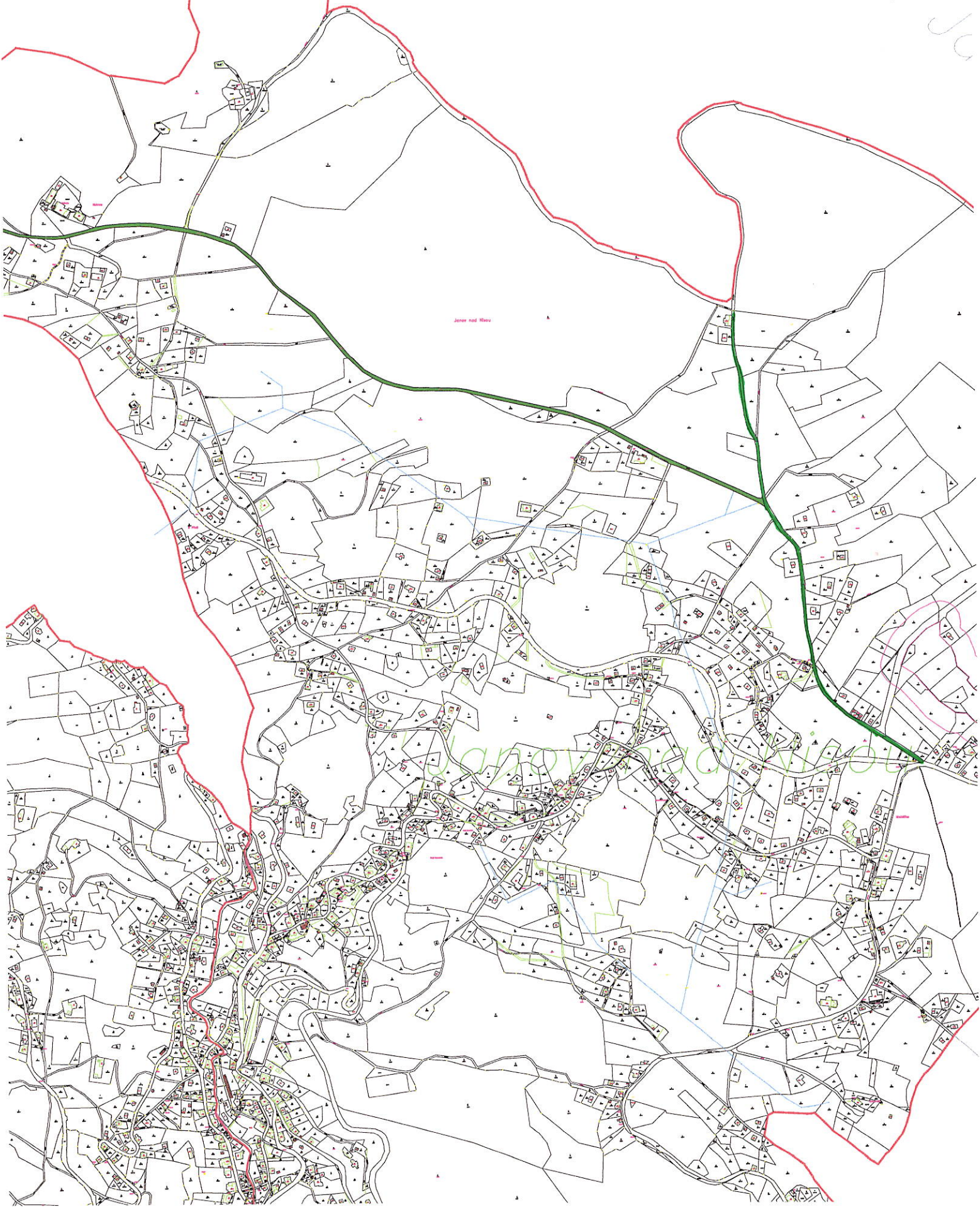

Jener und Wess

Copyright

7b 884



1c # 886
814/4

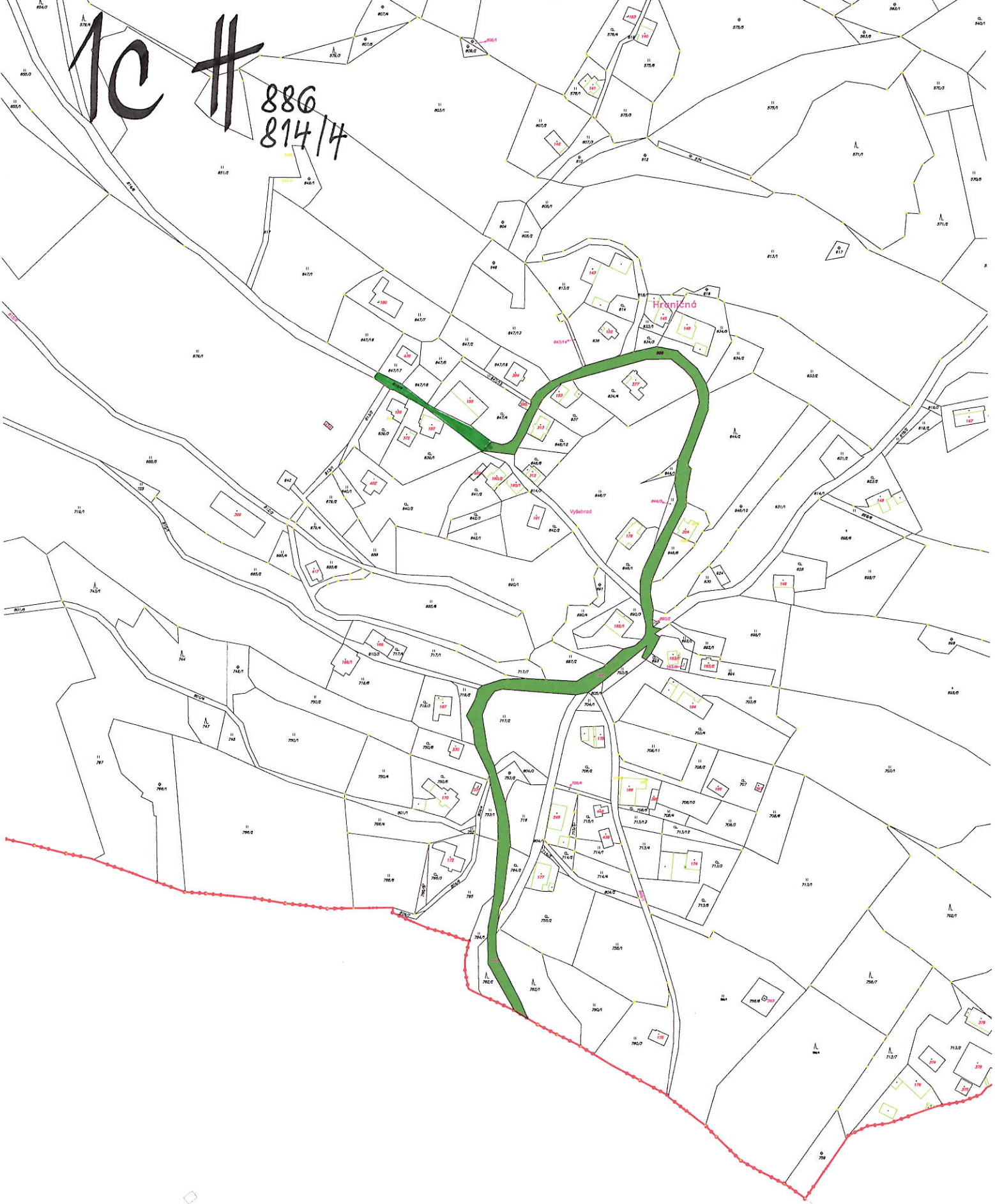

WICE

2c H+L

822/2
823/1

1785



40 L

1489/1; 1797; 1749; 1750/1; 1750/3; 1437/5; 1744

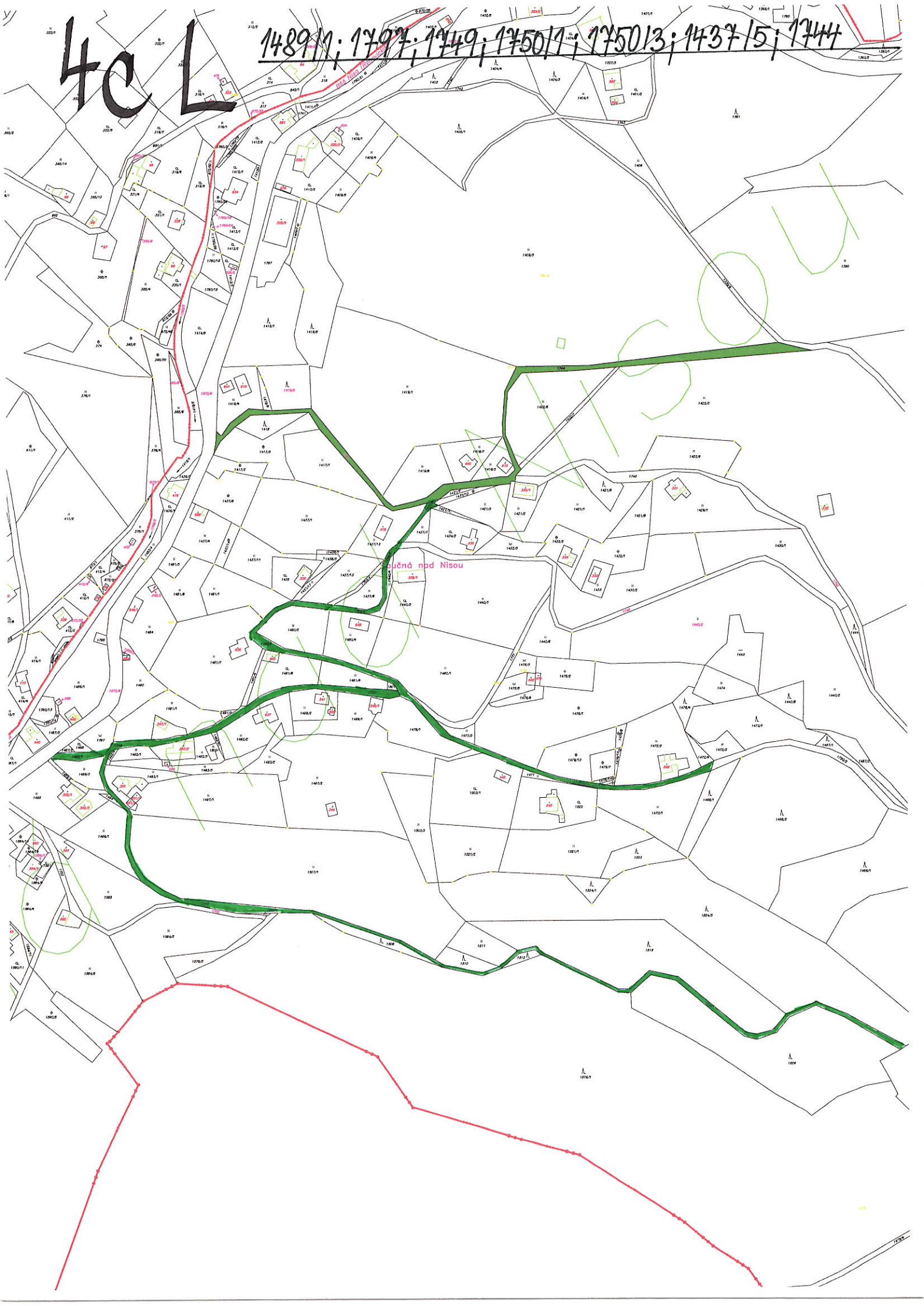

5e L+ff
1947

845/1; 891/1; 891/2; 892; 834/2; 833/2

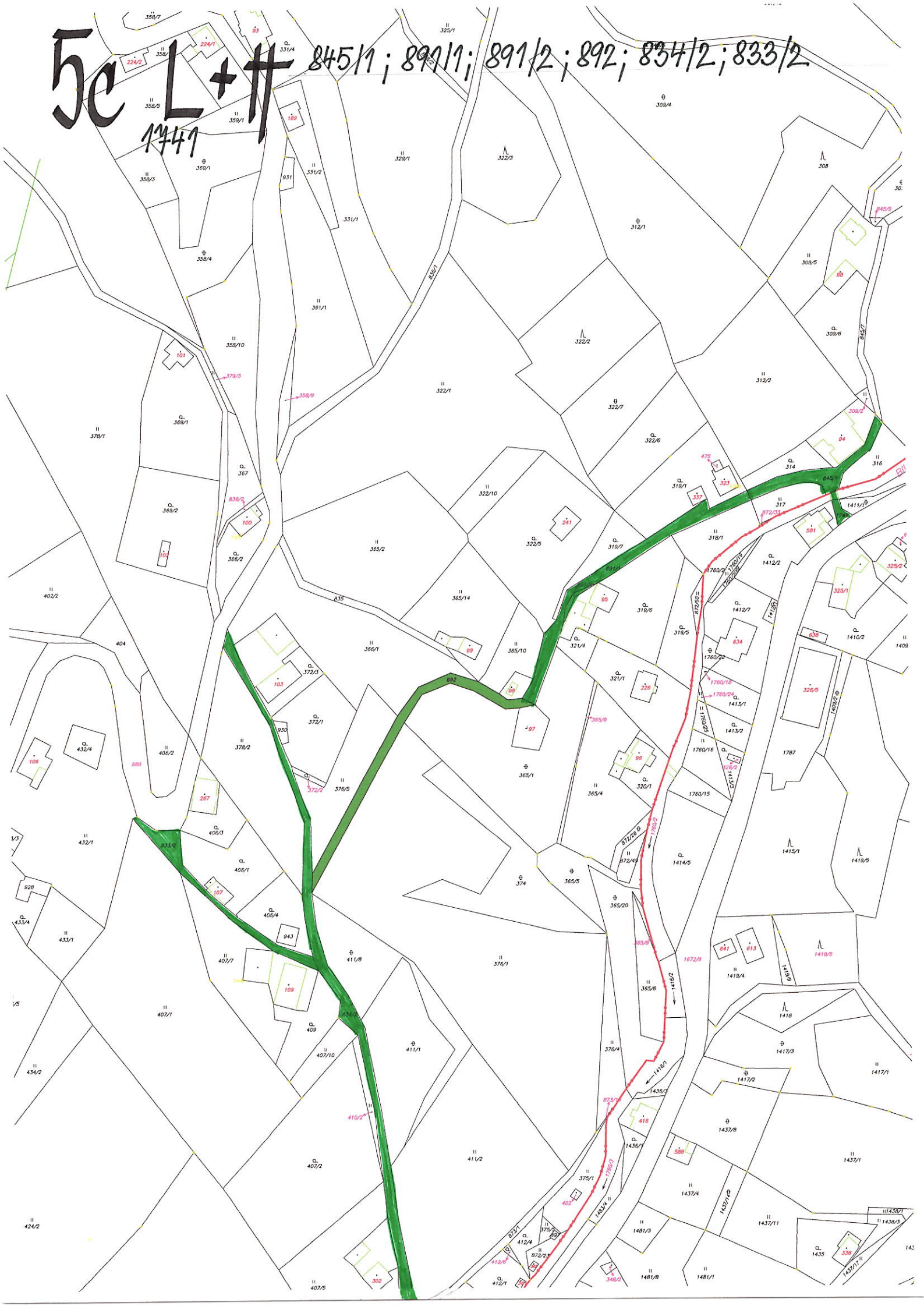

6c

L+J

1072/1

1326/1

Velký Šmerink

Rábenka

Rábenka

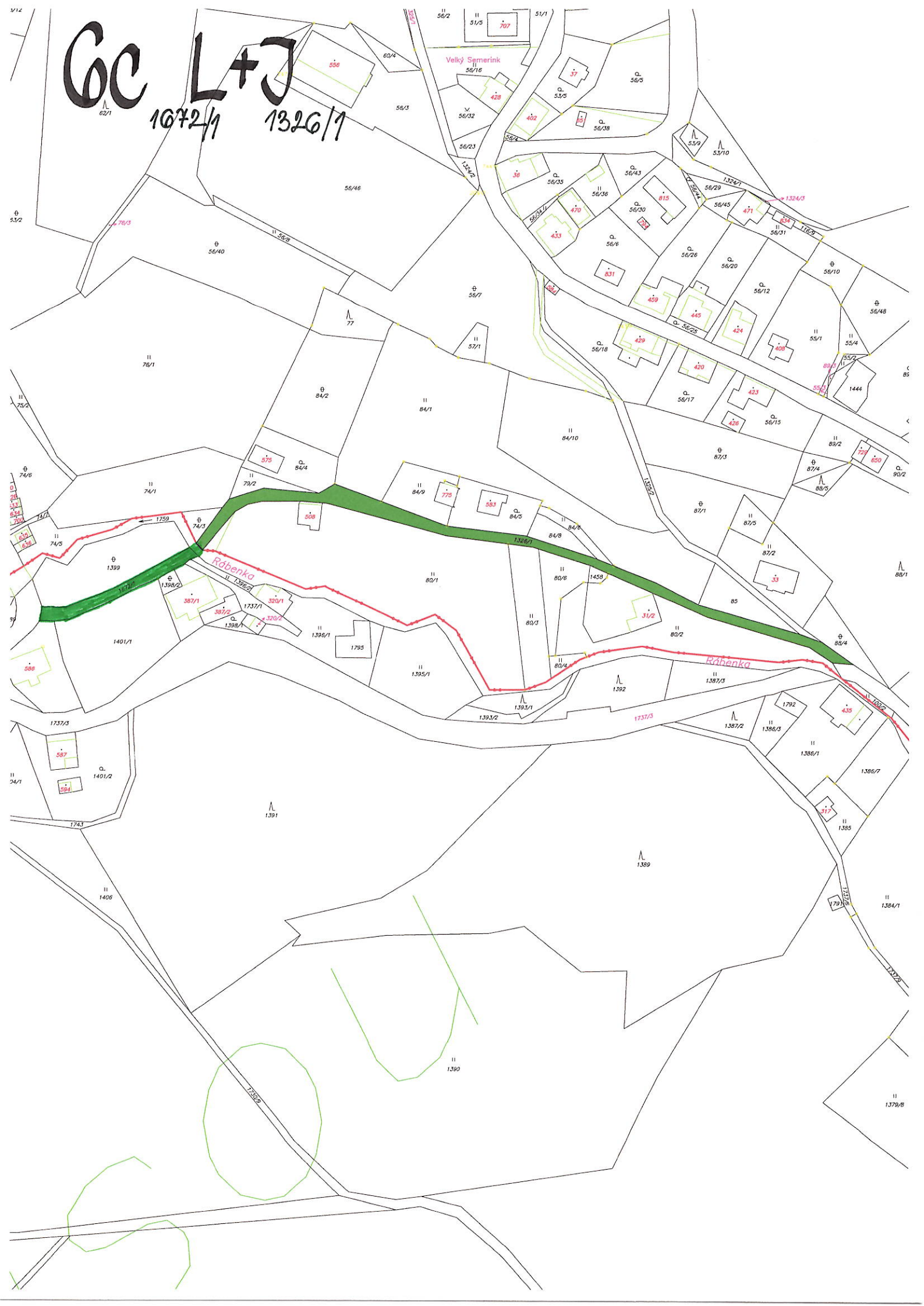

7c J
80 J

1401
1397/1
1402/1
1397/1
1329/6

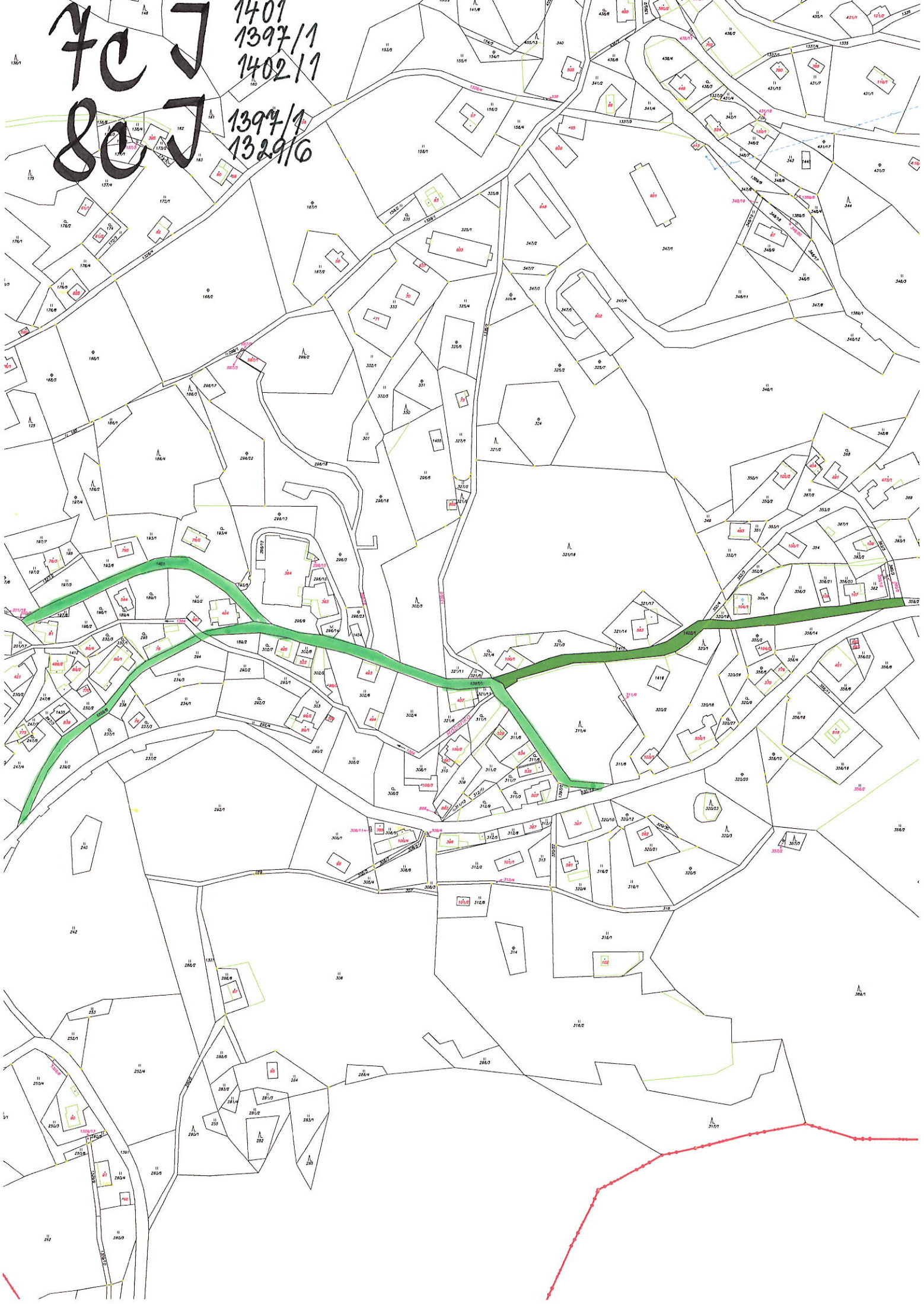

9c

420/3; 1332/1; 1332/2

85u

1333

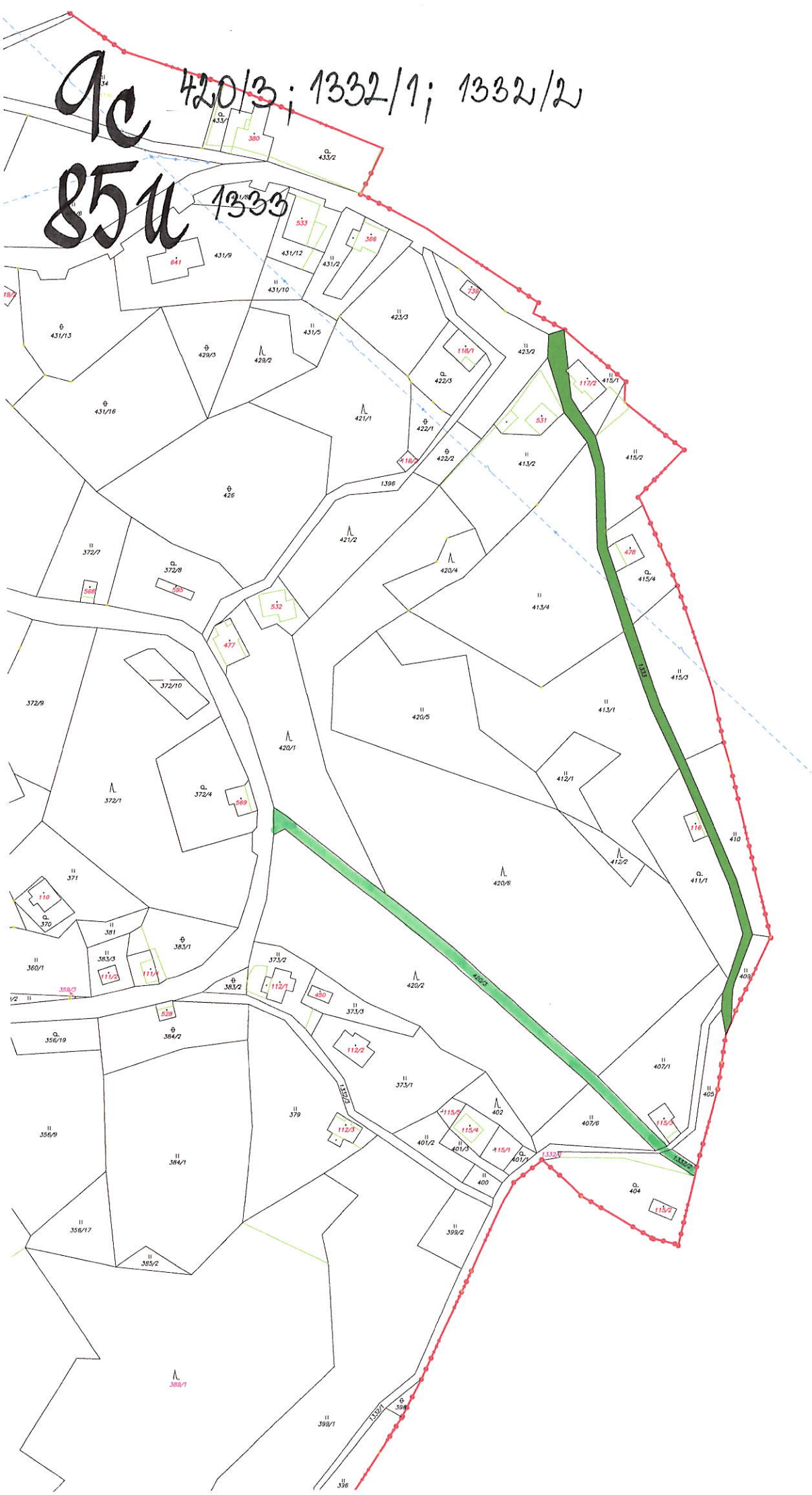

11c J
10c J # J: 132/1
12c J # H: 264/9; 870/2; 266/3
24/3

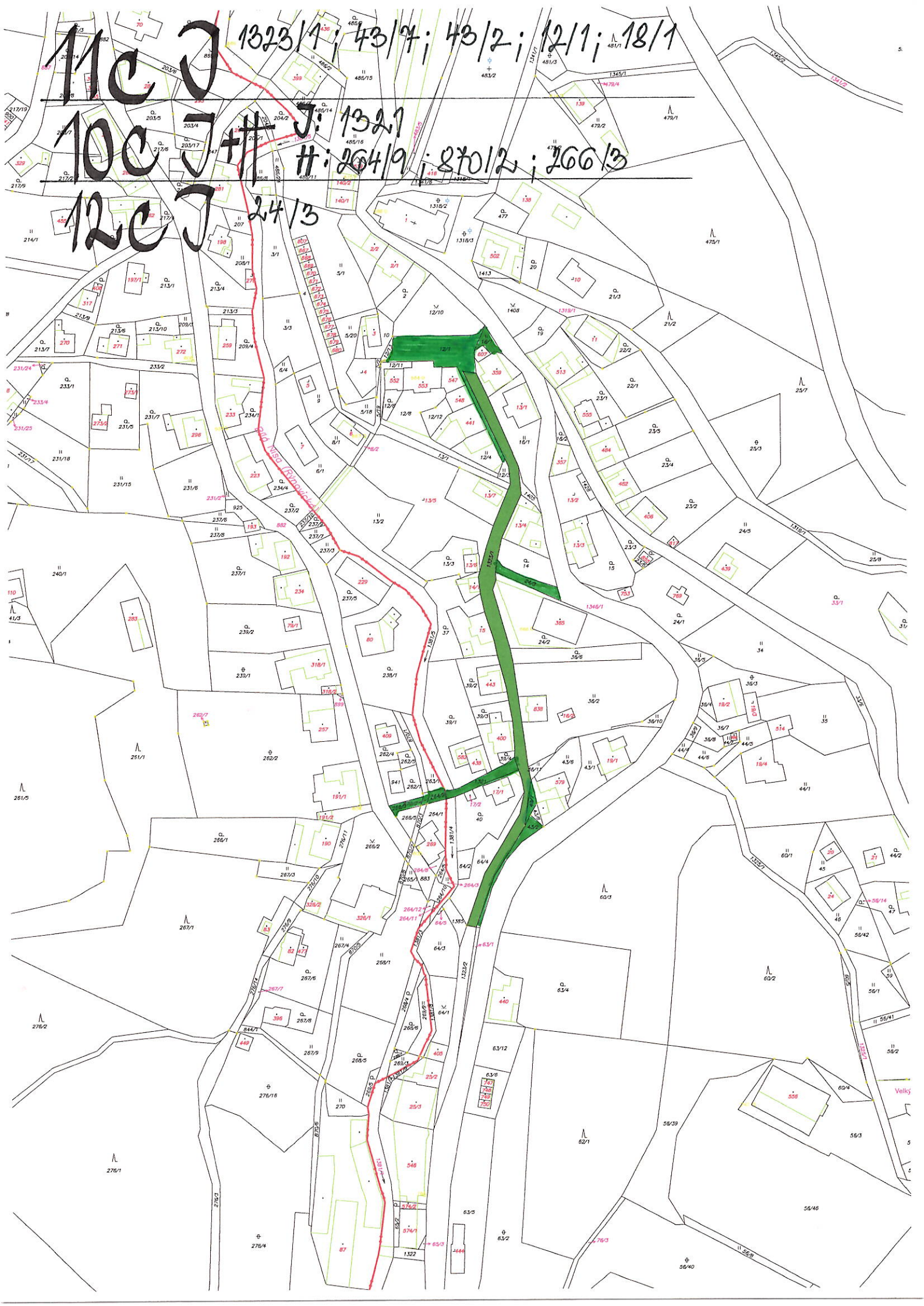

13c J+H

486/12
439/4

847/
237/14

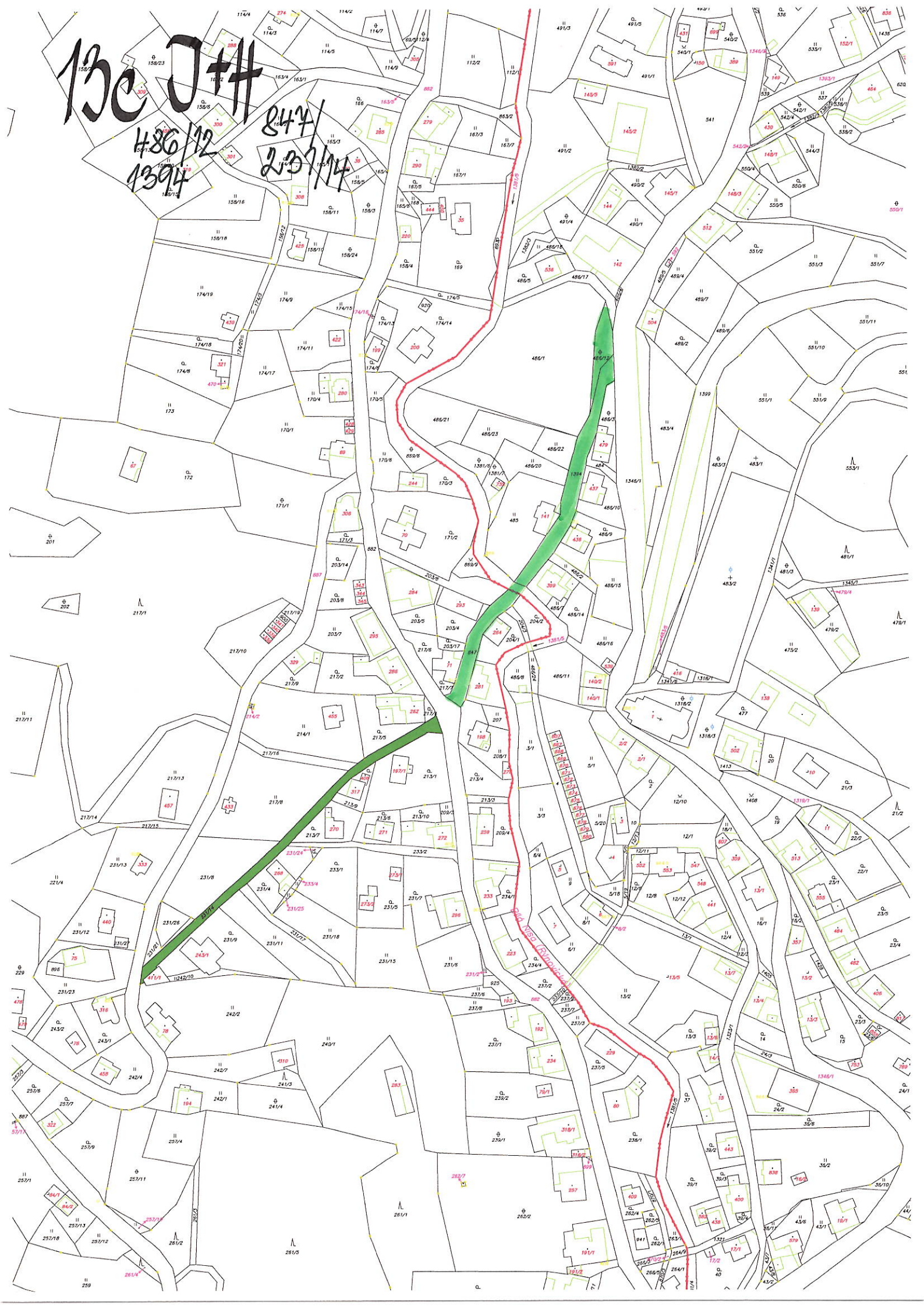

14c J 1350

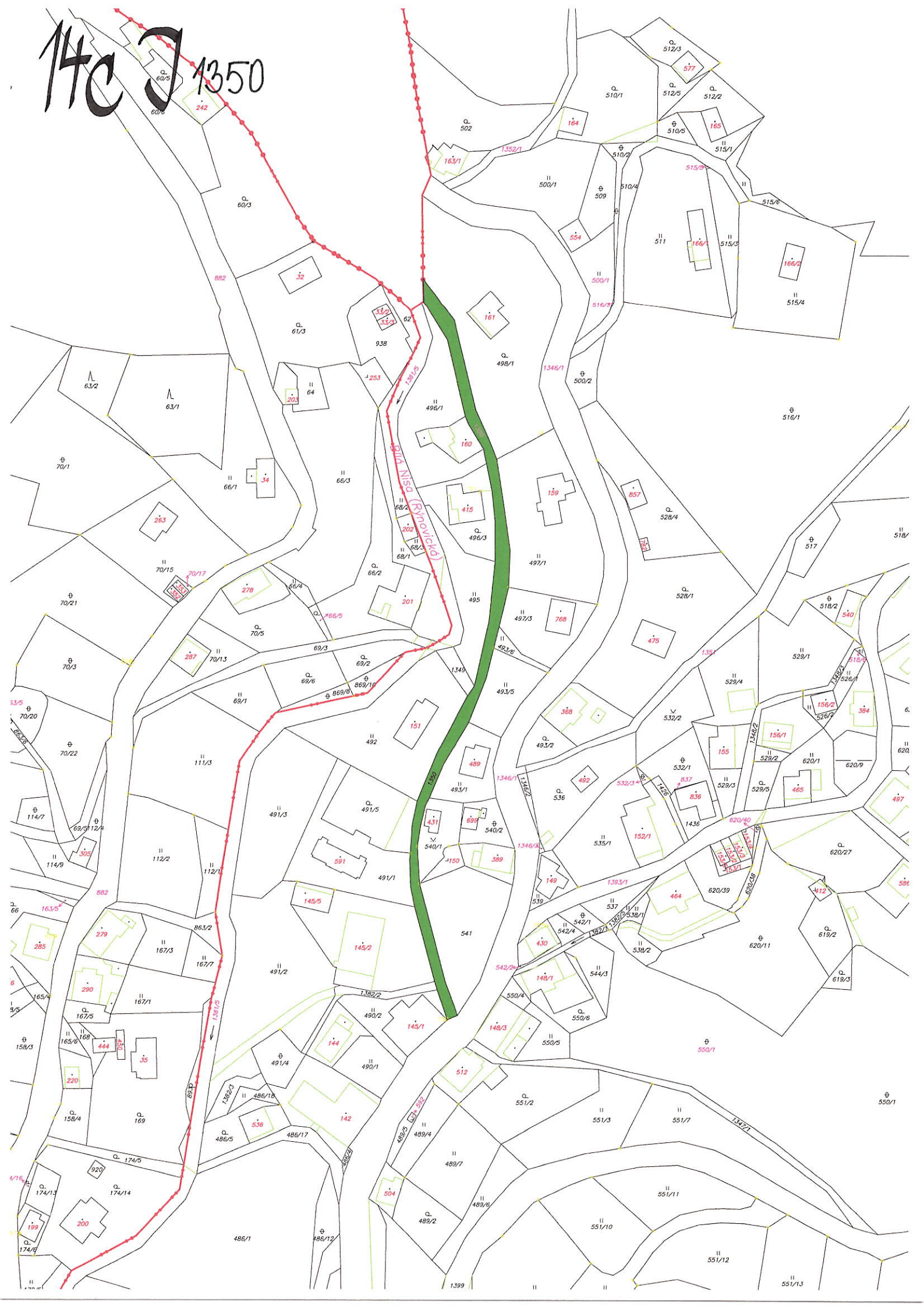

15c

724/8
673/6
1398/1



1d J 1400/1

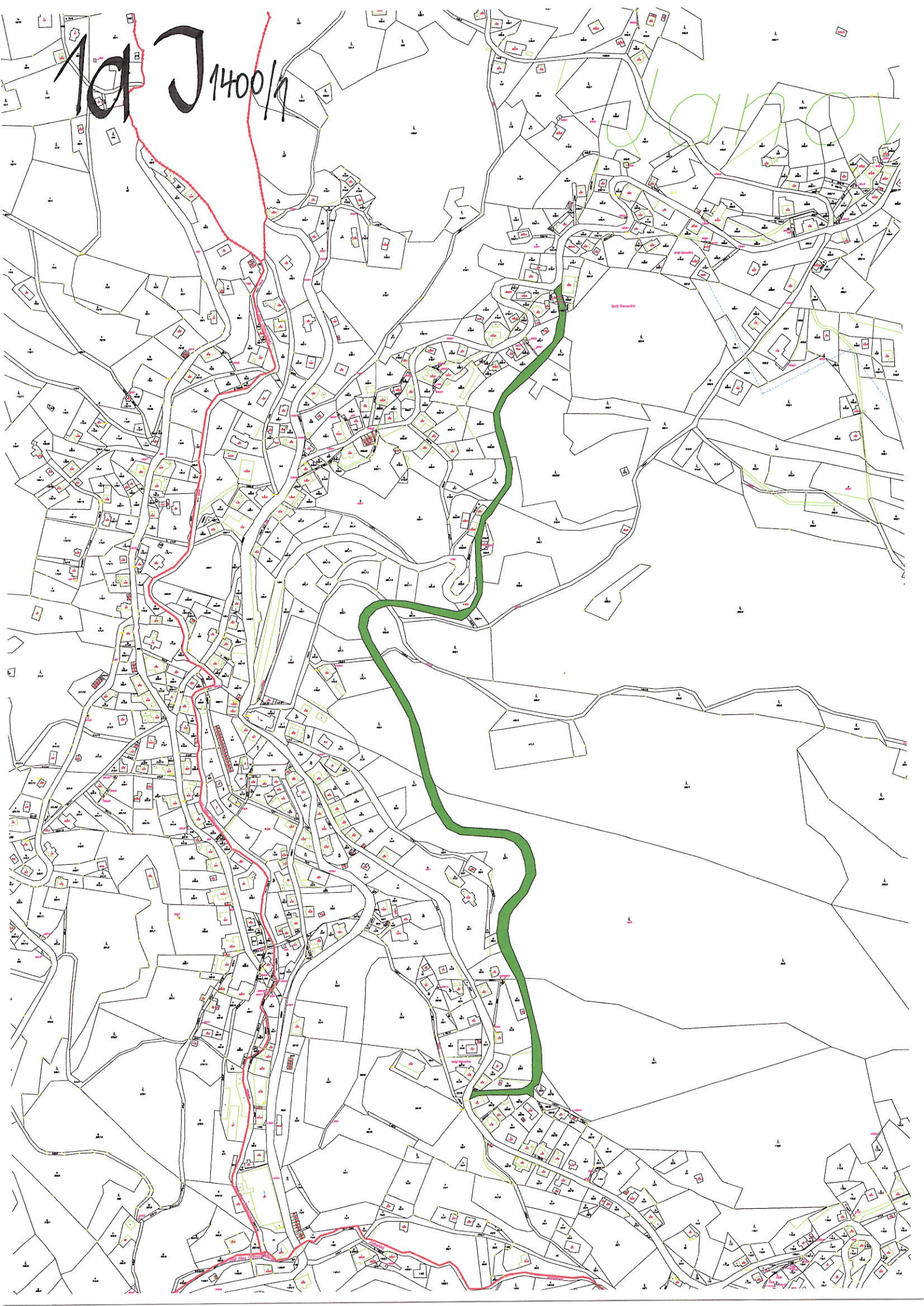

2d J+H J: 12/13; 5/2; 5/19; 8/2; 13/2;
H: 237/10

29w H: 5/19; 13/1; 1405

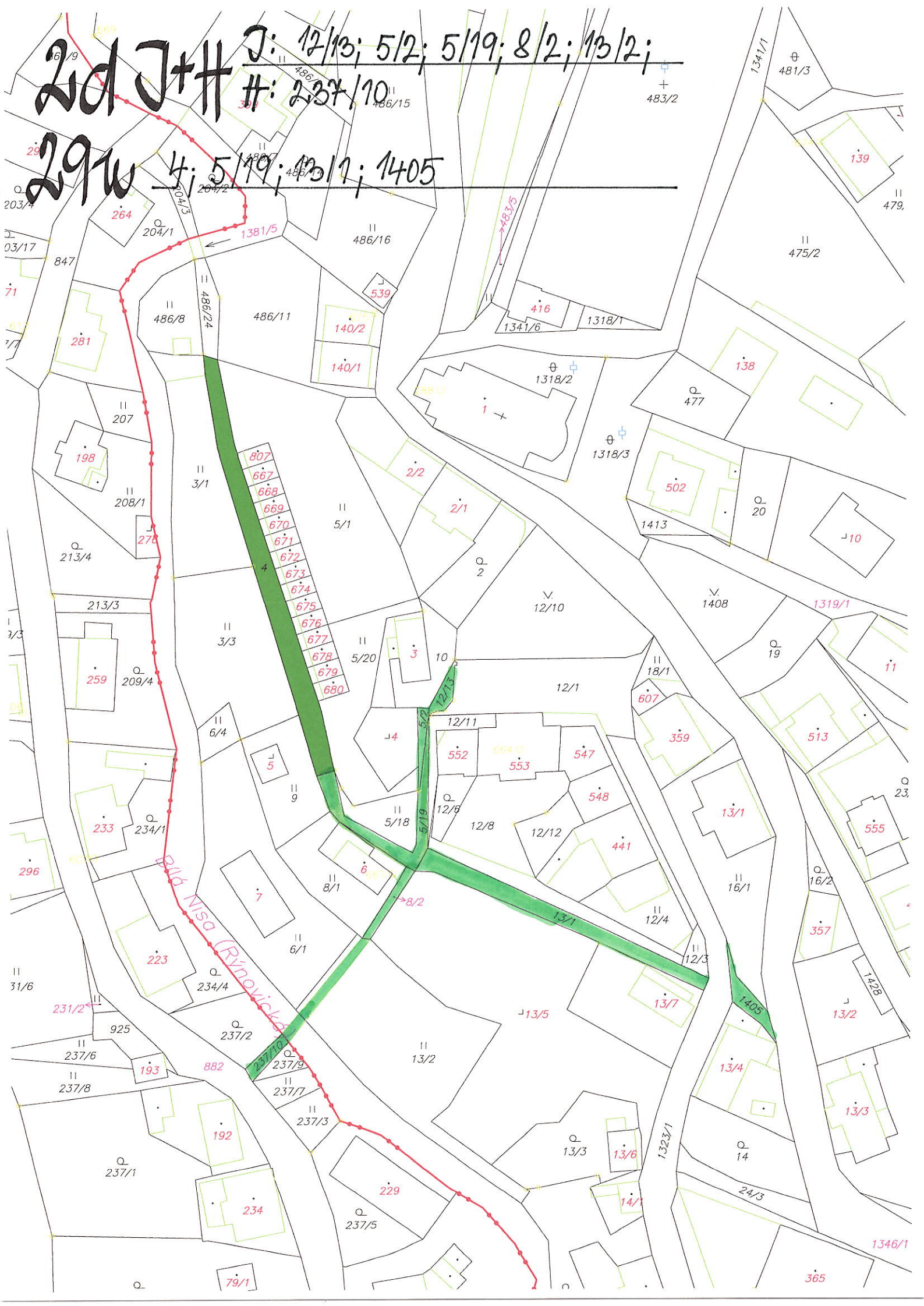



3d J+H

486/24

204/34

170/6

1381/6

486/20

1394

484

1346/1

1381/7

739

437

486/10

II
485

141

Q
486/9

436

Q
171/2

V
869/9

669

203/6

II
486/2

II
486/15

284

399

293

II
486/7

Q
486/14

Q
203/5

Q
203/4

Q
204/2

264

1381/5

II
486/16

Q
217/6

Q
203/17

Q
204/1

847

486/11

II
486/16

286

Q
217/7

71

281

II
486/8

II
486/24

675

140/2

140/1

262

Q
217/4

II
207

880

1

15

198

II
208/1

II
3/1

II
5/1

2/2

2/1

197/1

Q
213/1

Q
213/4

276

4

- 807
- 667
- 668
- 669
- 670
- 671
- 672
- 673
- 674
- 675
- 676
- 677
- 678
- 679
- 680

Q
2

Q
3/6

Q
213/10

II
209/3

213/3

II
3/3

II
5/20

3

10

71

272

Q
209/4

259

II
6/4

4

12/13

12/11

233/2

→483/5

132

